

lagoon® Advanced Care

WH6-33LAC and TD6-37LAC

The ideal replacement for any dry-cleaning operation



Features and benefits



Keep customers coming back

Outstanding results for garments of every type thanks to specialized detergents and dedicated programs



Delicate on the delicates

Gentle on fine textiles and wools labelled dry-clean only, as less mechanical action. Woolmark-approved



Rapid return on investment

With a better loading factor, less prespotting, easier finishing and faster process times



Sustainable and eco-friendly

Water-based cleaning with none of the disadvantages of PERC, which can be dangerous to staff



Dry to dry in 1 hour

Smart chemicals and processes mean garments are fully dried in the dryer - no hang-dry

Main specifications				WH6-33LAC
Rated capacity Laundry	filling factor 1:9	kg		33
	Wool filling factor	kg		23
	Silk 1:13 filling	kg		16
Drum, volume	factor 1:18	litre		300
	diameter	ø mm		795
Extraction		rpm		1005
G-factor				450
Heating alternative	electricity	kW		23.0
Consumption data "lagoon"				
Total time	Wool High	min		27
	Wool Medium	min		26
	Silk	min		19
	Synth. mix Medium	min		27
	Synth. mix Low	min		22
	Curtains	min		26
Water consumption (cold+hot)		litre		170
	Wool High	litre		136
	Wool Medium	litre		121
	Silk	litre		133
	Synth. mix Medium	litre		121
	Synth. mix Low	litre		174
	Curtains	litre		174
Energy consumption (motor/heating/water)		kWh		0.7/1.6
	Wool High	kWh		0.7/1.25
	Wool Medium	kWh		0.6/0.85
	Silk	kWh		0.6/1.55
	Synth. mix Medium	kWh		0.6/1.4
	Synth. mix Low	kWh		0.7/1.2
	Curtains	kWh		0.7/1.2
Consumption data ECO 60 1:9*				
Total time		min		65
Water consumption (cold+hot)		litre		196+14
Energy consumption (motor/heating/hot water)		kWh		0.6/3.95/0.75
Residual moisture		%		45
* Water temperature 15°C cold water and 65°C hot water.				

Main specifications				TD6-37LAC		
Rated capacity, Drying	filling factor 1:18	kg		37.5		
Drum, volume		litre		675		
	diameter	ø mm		913		
Heating alternative	electricity	kW		40.0		
	gas	BTU/h (kW)		14 3400 (42.0)		
	steam at 600-700 kPa			46.0		
Consumption data "lagoon"				El	Gas	Steam
Total time	Wool High*	min		22	22	21
	Wool Medium*	min		20	20	20
	Synthetic mix**	min		13	13	13
Consumption data***						
Total time		min		23	23	22
Energy consumption (motor/heating/hot water)		kWh		15.08	16.42	19.27
Evaporation		g/min		676	653	700
Energy/Water evaporation		kWh/l		0.98	1.07	1.26
* 1:30 load 100% wool load at 30% initial moisture dried to 0%.						
** 1:40 load 100% synthetic load at 20% initial moisture dried to 0%.						
*** At rated capacity 100% cotton load at 50% initial moisture dried to 0%.						

Electrical connections

Heating alternative	Main voltage		Heating power kW	Total power kW	Recommended fuse A	
	Hz	~				
Electric heated	220-230V	3 ~	50/60	19.1	20.2	63
	220-240V	3 ~	50/60	19.8/23.0	20.9/24.1	63/63
	380-400V	3N ~	50/60	19.1	20.2	32
	380-415V	3N ~	50/60	19.8/23.0	20.6/24.1	32/50
Steam or Non heated	220-415V 1/1N ~		50/60	*	1.3	10

* Total power and recommended fuse does not depend on the heating power in those cases.

** Prepared for 3 ~.

Water and steam connection

		WH6-33LAC
Water valves	DN	20
Water pressure	kPa	200-600
Capacity at 300 kPa	l/min	60
Drain valve	ø mm	75
Draining capacity	l/min	170
Steam valve	DN	15
Steam pressure	kPa	300-600
Liquid detergent supplies		5

Floor requirements

Frequency of the dynamic force	Hz	15.8
Floor load at max extraction	kN	6.2 ± 1.3

Sound levels

Sound power/pressure level at extraction*	dB(A)	82/66
Sound power/pressure level at wash*	dB(A)	66/50

Heat emission

% of installed power, max		5
---------------------------	--	---

Shipping data**

Weight	net, kg	560
Shipping volume	m ³	2.04

Accessories

Steel base		x
Hose kits for water or steam		x
Fluff collector		x

Dimensions in mm

A Width		1020
B Depth		1135
C Height		1445
D1		490
D2		555
E		2000
F		1165
G		135
H		1365
I		400
J		300
K		1325
L		1245
M		335
N		100
O		360
P		340
Q		215

1 Display	
2 Door opening ø 435 mm	7 Cold/Hot water or Re-used water with network pressure (option)
3 Detergent box	8 Re-used water from tank/pump or Liquid detergent supply
4 Cold/Hot water (Detergent box)	9 Drain
5 Cold water	10 Liquid detergent supply
6 Hot water	11 Electrical connection
	12 Steam connection

* Sound power levels measured according to ISO 60704.

** Average data. Crated weight/shipping volume depends on configuration. Please contact logistics for exact measures.

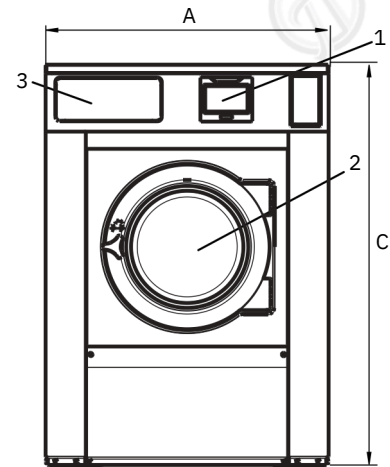

Front

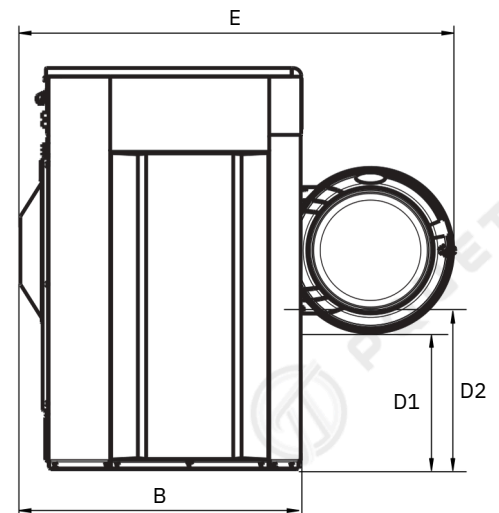

Side view

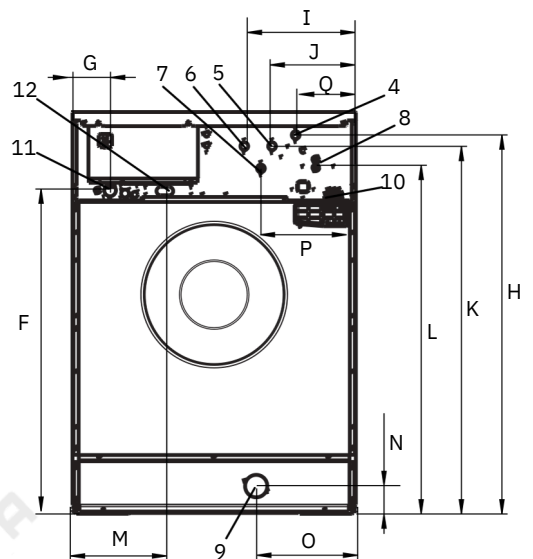

Rear

Electrical connections				
Heating alternative	Main voltage Hz	Heating power kW	Total power kW	Recommended fuse A
Electric heated	200-240V 3~	32.0/40.0	33.5/41.5	100/125
	380-415V 3N/3~ 50/60	32.0/40.0	33.5/41.5	50/63
	440V 3~ 60	32.0/40.0	33.5/41.5	50/63
	480V 3~ 60	32.0/40.0	33.5/41.5	50/63
Gas heated/ Steam heated	220-240V 1/1N~ 50/60	-	1.8	10
	220-480V 3/3N~ 50/60	-	1.5	10

* Total power and recommended fuse does not depend on the heating power in those cases.

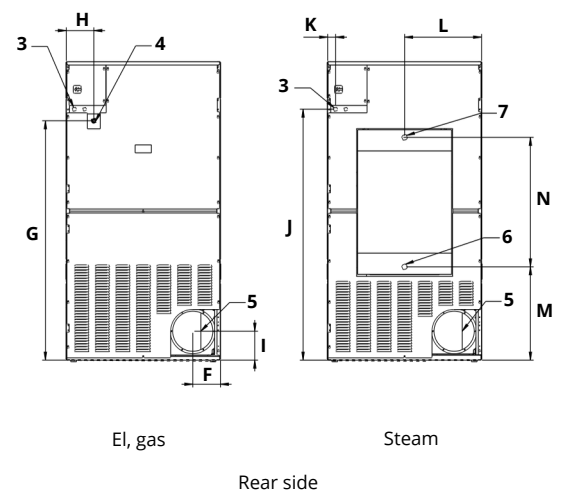
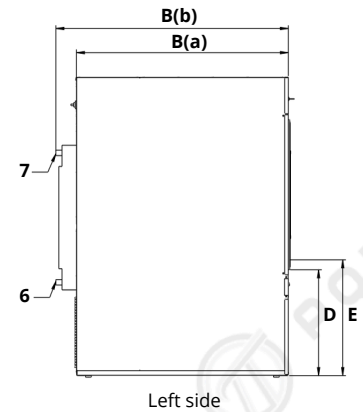
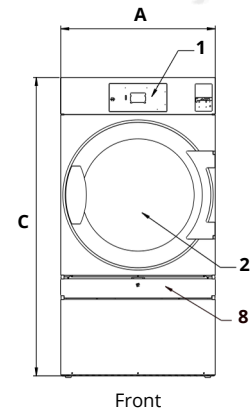

Steam, gas and air connections		TD6-37LAC	
Steam		ISO 7/1-R	1"
Steam pressure		kPa	100-1000
Steam consumption		kg/h	65
Condensate		ISO 7/1-R	1"
Gas	NG/PG	ISO 7/1-R	1/2"
Gas pressure	Natural gas	Pa	2000
	Propane	mbar	20
		Pa	2800-3700
		mbar	28-37
Air outlet		mm	200
Maximum air flow:		m ³ /h	1140 / 1140
	Electric 50 Hz / 60 Hz	m ³ /h	1140 / 1140
	Gas 50 Hz / 60 Hz	Pa	1380 / 1380
	Steam 50 Hz / 60 Hz	Pa	
Maximum static back pressure:		Pa	270 / 800
	Electric 50 Hz / 60 Hz		410 / 800
	Gas 50 Hz / 60 Hz		900 / 1100
	Steam 50 Hz / 60 Hz		
Sound levels			
Sound power/pressure level at drying*		dB(A)	74/57
Heat emission			
% of installed power, max			15
Shipping data**			
Shipping volume		net, kg	283
		crated, m ³	3.25
Dimensions in mm			
A	Width		960
B(a)	Depth		1560
B(b)	Depth		1640
C	Height		1855
D			660
E			720
F			170
G			1490
H			200
I			180
J			1560
K			50
L			480
M			580
N			805
1 Control panel			
2 Door opening ø 810 mm			
3 Electrical connection			
4 Gas connection			
5 Exhaust connection			
6 Condensate connection			
7 Steam connection			
8 Lint screen			

* Sound power levels measured according to ISO 60704.

** Average data. Crated weight/shipping volume depends on configuration. Please contact logistics for exact measures.



Jetsave PNCs	Description
988930001	Complete kit with 2 pumps, 550 ml/min
988930002	Complete kit with 3 pumps, 550 ml/min
988930003	Complete kit with 4 pumps, 550 ml/min
988930004	Complete kit with 5 pumps, 550 ml/min

Accessories PNCs	Description
988916611	Single low level probe
432930071	Extension POWER cable (6m)
432930072	Extension DATA cable (6m)
988930031	ID interface for 3rd part party peristaltic pumps or option for Low level alarm
432930065	Joining kit

Power supply
From the washer extractor: 100-240V~ 50/60 Hz / 0.1A (Max)

Water supply
Min. 1.8 bar
Max. 6 bar

Electrolux Professional name and description	Packaging 20 litres	Packaging 10 litres
W01 - lagoon Sensitive Detergent Professional detergent for natural/animal fiber	432731085	432731086
W03 - lagoon Sensitive Conditioner Professional conditioner for natural/animal fiber	432731087	432731088
W02 - lagoon Delicate Detergent Professional delicate universal detergent	432731089	432731090

For further information including spotting agents, please refer to the lagoon detergent Product Data Sheet



BASE; closed front and sides



Suitable for models: WH6-33LAC
988919071

Height: 230 mm

Material: Galvanised, silver grey painted steel
with stainless steel front panel.